

The square footages and room size information are deemed to be reliable but are not guaranteed and should be independently verified.

62 E Morning Ridge Pl

Presented by Pam Treece

Long Realty Company

(520) 275-2664

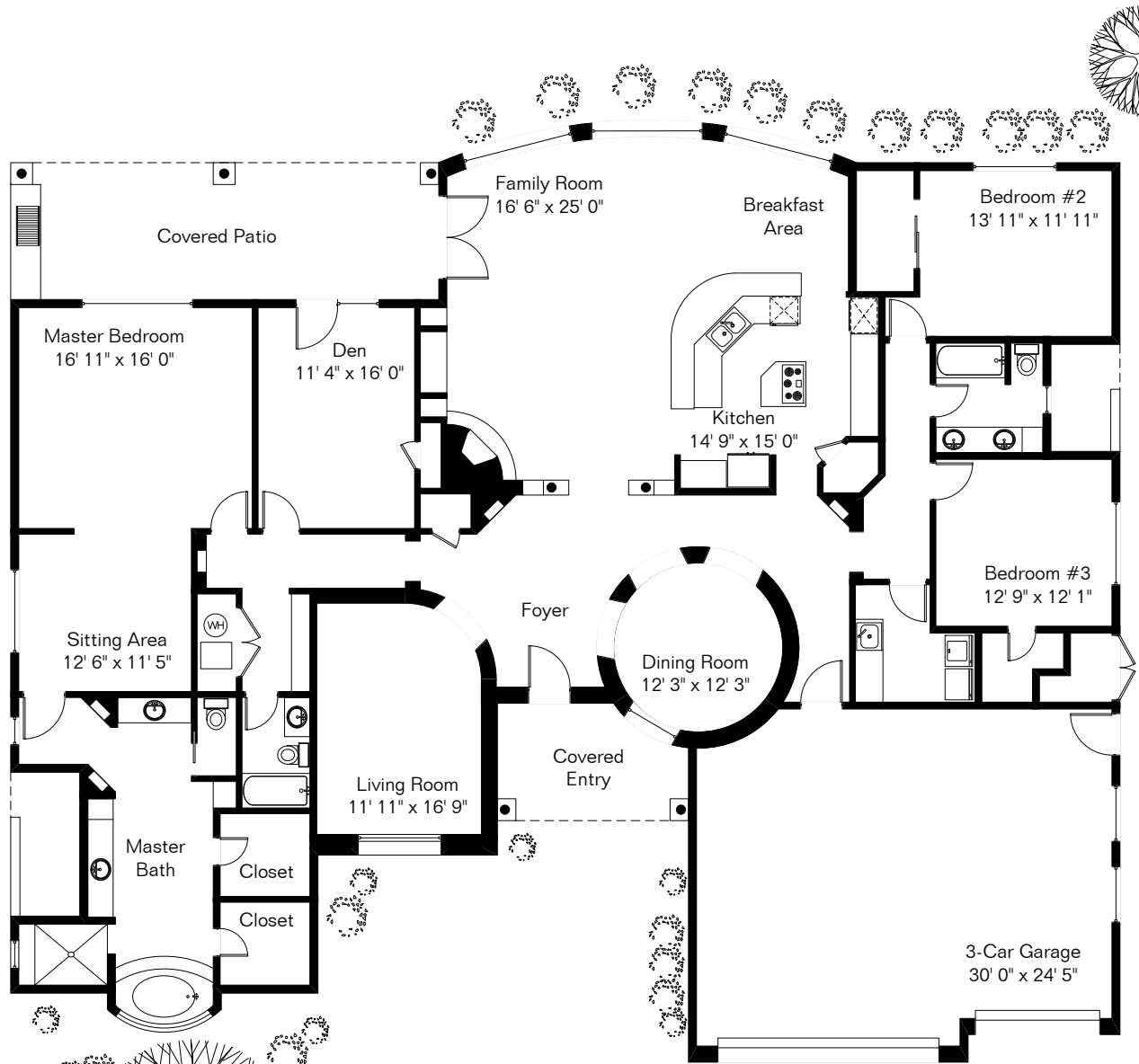

Living Area 3,453 Sq Ft

Garage 767 Sq Ft

Site Visit October 2017

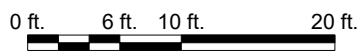

Copyright 2017 Floor Plans First! LLC
All Rights Reserved.

www.FloorPlansFirst.com

Toll Free (877) 887-1500
Voice (520) 881-1500
Fax (520) 791-7701

